



Acoustic cabinet fans specifically designed to provide ventilation solutions for dwelling applications.

- Low profile acoustic cabinet fans with sound absorbent insulation.
- Square duct connection flange on the inlet and outlet.
- Suitable for mounting in any orientation and operation within ambient air temperatures between -15°C up to +55°C.

Construction

- Fan casing manufactured from heavy gauge sheet steel and internally lined with 7mm thickness of melamine foam.
- High efficiency direct drive backward centrifugal impeller.
- IP54, class F external rotor motor with thermal overload protection, suitable for single phase supply 230V/50-60Hz.
- Fan supplies with four mounting feet and external connection box to ease the installation.

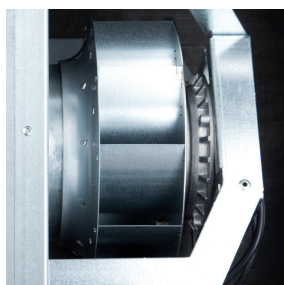

Direct drive backward centrifugal impeller.



IP55 External connection box.

TECHNICAL CHARACTERISTICS

Model	Main supply (V/Hz)	Speed (rpm)	Max.abs. power (W)	Max.abs. current at 230V (A)	Max. airflow (m³/h)	Sound pressure level ** (dB(A)) at 1,5 m			Weight (kg)
						Inlet	Radiated	Outlet	
CAB-100-EL	230/50	2530	34	0,1	280	45	36	39	3,7
	230/60	2800	40	0,2	310	47	38	40	
CAB-125-EL	230/50	2640	61	0,3	440	51	40	46	5,1
	230/60	2880	85	0,4	470	53	41	47	
CAB-160-EL	230/50	2580	106	0,5	760	57	43	52	6,7
	230/60	2740	145	0,6	790	59	44	53	
CAB-200-EL	230/50	2680	149	0,6	1010	57	44	53	7,9
	230/60	2980	212	0,9	1120	59	45	54	
CAB-250-EL	230/50	2700	210	0,9	1250	61	46	57	9,1
	230/60	3010	306	1,3	1370	63	47	58	

*Sound pressure level measured in free field condition at 1,5m, at the medium working point on the performance curve.

DIMENSIONS (mm)

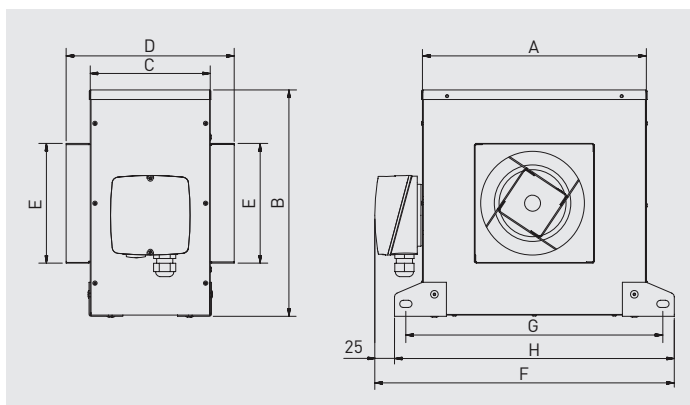

Model	A	B	C	D	E	F	G	H
CAB-100-EL	280	284	150	210	150	375	322	350
CAB-125-EL	333	336	175	235	165	427	374	403
CAB-160-EL	385	389	200	261	200	480	427	455
CAB-200-EL	394	397	235	295	225	488	435	464
CAB-250-EL	438	441	245	305	290	533	480	508

PERFORMANCE CURVES

- q_v : Airflow in m^3/h and m^3/s .
- p_{st} : Static pressure in Pa.
- Dry air at 20°C and 760 mmHg.
- Performance data in accordance with ISO 5801 and AMCA 210-99 Standards.
- Sound pressure levels (L_p dB(A)) measured at inlet, at 1,5 meters distance.

